



6 Nicholas Grove
Leek



Estate Agents. Valuers. Auctioneers. Chartered Surveyors
Part of the Bagshaws Partnership

6 Nicholas Grove

Leek
Staffordshire
ST13 8NT

- * An extended three bedroom semi-detached property situated in a highly regarded location in the west end of town, convenient for schools of all ages.
- * The property requires updating and improvement throughout but offers lots of potential and a blank canvas to go in and put your own mark on the property.
- * Boasting a quiet cul-de-sac position and occupies a generous sized plot.
- * The property benefits from majority Upvc double glazing and gas fired central heating.
- * Accommodation briefly comprises: Entrance Hall, W.c, Lounge / Dining Room, Sitting Room and Kitchen to the ground floor. Landing Area, Three Bedrooms and Bathroom to the first floor.
- * Driveway providing ample off street parking leading to a single garage.
- * Front and rear garden areas.
- * The property is offered For Sale with no upward chain involved.



Offers In The Region Of £220,000



3



1



3



D



acre(s)



Leek - 01538 383344



leek@buryandhilton.co.uk





General Information

Entrance Hall

Stairs off. Radiator. Understairs storage.

W.c

W.c. Wash basin.

Living Room 15'3" x 10'10" (4.65m x 3.30m)

Gas fire. Radiator.

Dining Room 10'10" x 8'4" (3.30m x 2.54m)

Radiator. Access to Kitchen. Sliding doors to:

Sitting Room 10'11" x 9'9" (3.33m x 2.97m)

Radiator. Sliding doors to side.

Kitchen 11'3" x 9'1" (3.45m x 2.79m)

Wall and base units. stainless steel sink unit with drainer and mixer tap. Gas hob. Electric oven. Central heating boiler. Rear door. Plumbing point. Tiled floor.

Landing Area

Airing cupboard.

Bedroom 10'9" x 8'7" (3.28m x 2.64m)

Radiator.

Bedroom 10'9" x 10'4" (3.30m x 3.15m)

Radiator. Loft access.

Bedroom 9'3" x 7'4" (2.82m x 2.24m)

Radiator. Storage cupboard.

Bathroom 6'5" x 5'10" (1.96m x 1.78m)

Bath with shower over. W.c. Wash basin. Radiator.

Outside

Driveway providing ample off street parking leading to a single garage. Front and rear garden areas.



GROUND FLOOR

APPROX. 55.5 SQ. METRES (597.0 SQ. FEET)

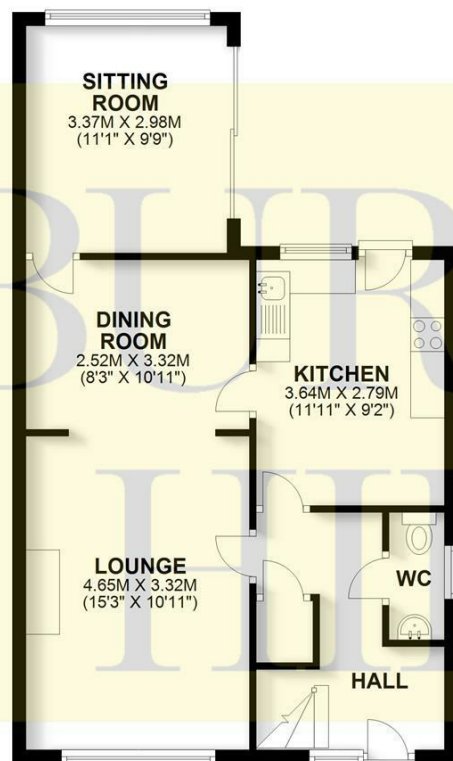

FIRST FLOOR

APPROX. 37.0 SQ. METRES (398.2 SQ. FEET)



TOTAL AREA: APPROX. 92.5 SQ. METRES (995.2 SQ. FEET)

Plan produced by www.firstpropertyservices.co.uk. We accept no responsibility for any mistake or inaccuracy contained within the floorplan. The floorplan is provided as a guide and should be taken as an illustration only. The measurements, contents and positioning are approximations only and provided as a guidance tool and not an exact replication of the property.
Plan produced using PlanUp.

Agents Notes

Bury & Hilton have made every reasonable effort to ensure these details offer an accurate and fair description of the property. The particulars are produced in good faith, for guidance only and do not constitute or form an offer or part of the contract for sale. Bury & Hilton and their employees are not authorised to give any warranties or representations in relation to the sale and give notice that all plans, measurements, distances, areas and any other details referred to are approximate and based on information available at the time of printing.

BURY & HILTON
EST. 1963
Part of the Bagshaws Partnership

6 Market Street, Leek, Staffordshire, ST13 6HZ

T: 01538 383344

E: leek@buryandhilton.co.uk

www.buryandhilton.co.uk

Part of the Bagshaws Partnership

BAGSHAWS
EST. 1897
Land · Property · Livestock

Offices in:

Ashbourne	01335 342201
Bakewell	01629 812777
Buxton	01298 27524
Leek	01538 383344
Penkridge	01785 716600
Uttoxeter	01889 562811

arla | propertymark

